

AMAXX® network enclosure
Part no. 25102GE



- network enclosure made of AMAPLAST
- protection type IP 44
- top part electric grey RAL 7035 or yellow RAL 1021, bottom part black with screw-in nuts for installation of a floor-mounted base including a height-adjustable mounting rail
- cable gland set with multiple seal

Technical specifications

Data port sockets	2 Cepex data port sockets identical lock, prepared for 4 RJ45 connection module couplings, type E-DAT module, port, cat.6, brand: BTR (part no. 41455) or OpDAT module LC or ST (brand BTR - not delivery contains)
Connection / feeder cable	<ul style="list-style-type: none"> • each x M 25 top and bottom (sealed) • each x M 20 top and bottom (sealed) • cable gland M 25 bottom (multiple seal with 3 openings for a cable diameter of 5-7 mm including suitable blanking plugs, 1 cap-shape seal blank for punched hole)
Protection type	[IP 44, ClassificationAttributeValueModel (8796126610016@50)]
Shutter	false
Enclosure material	Plastic
Weight	1414 g
Height	130 mm
Width	225 mm

Drawing

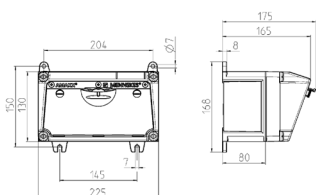

Drawing 1 MB 531

Depth dimensions at various fittings.

Receptacles	Degrees	Depth
SCHUKO® 16A, 230 V	IP 44	175 mm
	IP 67	194 mm
CEE 16A, 3p, 230V	IP 44	204 mm
	IP 67	205 mm
CEE 16A, 5p, 400V	IP 44	209 mm
	IP 67	213 mm
CEE 32A, 5p, 400V	IP 44	221 mm
	IP 67	227 mm
CEE 63A, 5p, 400V	IP 44	248 mm
	IP 67	248 mm

Cable entries: closed for cut out. 2 x M 25 each on top and bottom, 2 x M 20 each on top and bottom for cut out.