

## Panel mounted socket with TwinCONTACT

Part no. 1733



- screwless spring terminals
- suitable for through wiring
- 20° inclination
- 32 A sockets are designed for adding an auxiliary contact switch

### Technical specifications

|                           |                         |
|---------------------------|-------------------------|
| Ampere                    | 32 A                    |
| Poles                     | 3 p                     |
| Voltage                   | 110 V                   |
| Clock position            | 4 h                     |
| Hertz                     | 50-60 Hz                |
| Connection technology     | Screwless - TwinCONTACT |
| Contact                   | standard                |
| Protection type           | IP 44                   |
| Flange                    | 100x92 mm               |
| Fixing hole               | 85x77 mm                |
| Inclination               | 20 °                    |
| Weight                    | 120 g                   |
| Declaration of Conformity | EAC                     |

### Drawing

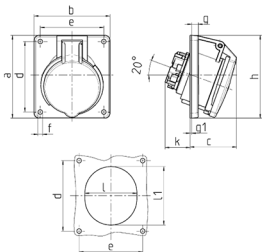

| Drawing<br>1 MB 465<br>Dim. in mm                                | Amp.<br>Poles | 16   |     |     | 32  |     |     |
|--|---------------|------|-----|-----|-----|-----|-----|
|  |               | 3    | 4   | 5   | 3   | 4   | 5   |
| a  |               | 73.5 | 100 | 100 | 100 | 100 | 100 |
| b  |               | 64   | 92  | 92  | 92  | 92  | 92  |
| c  |               | 52   | 58  | 58  | 61  | 61  | 60  |
| d  |               | 60   | 85  | 85  | 85  | 85  | 85  |
| e  |               | 52   | 77  | 77  | 77  | 77  | 77  |
| f  |               | 5.5  | 5.5 | 5.5 | 5.5 | 5.5 | 5.5 |
| g  |               | 7    | 8   | 8   | 8   | 8   | 8   |
| g-1  |               | 2    | 2   | 2   | 2   | 2   | 2   |
| h  |               | 79   | 100 | 100 | 103 | 103 | 105 |
| k  |               | 31   | 31  | 31  | 44  | 44  | 54  |
| l  |               | 52   | 55  | 65  | 70  | 70  | 73  |
| l1   |               | 60   | 63  | 72  | 82  | 82  | 85  |
| Terminal for cond. cross<br>section (mm <sup>2</sup> ) min.-max. |               | 1.5  | 1.5 | 1.5 | 2.5 | 2.5 | 2.5 |
|  |               | -4   | -4  | -4  | -6  | -6  | -6  |