

**Panel mounted socket**  
Part no. 20148A



- screw terminals
- **X-CONTACT**
- uniform fixing hole spacing
- sockets with pilot contact: part no. + index P

**Technical specifications**

Ampere	63 A
Poles	5 p
Voltage	400 V
Clock position	6 h
Hertz	50-60 Hz
Connection technology	Screw terminals
Contact	X-CONTACT®
Protection type	IP 67
Flange	110x106 mm
Fixing hole	90x90 mm
Inclination	15 °
Weight	727 g
Declaration of Conformity	VDE, EAC

**Drawing**

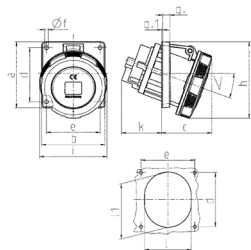

Drawing	Amp.	16	32	63	125
1 MB 580/601	Poles	5	5	4	5
Dim. in mm	a	110	110	110	114
	b	106	106	106	110
	c	55	59	84	75
	d	90	90	90	90
	e	90	90	90	90
	f	5.2	5.2	6.5	6.2
	g	8	8	12	13
	g.1	2	2	2	2
	h	110	115	128	133
	i	89	106	113	126
	k	28	46	64	103
	l	78	87	92	94
	l1	-	-	98	107
	<	15°	15°	20°	15°
Terminal for cond. cross		1.5	2.5	6	25
section (mm²) min.-max.		-4	-10	-20	-70