

## Panel mounted socket TM

Part no. 23175



- screw terminals
- highly heat resistant contact carrier
- nickel plated contacts
- straight
- (form AS)

## Technical specifications

Ampere	16 A
Poles	5 p
Voltage	50-500 V
Clock position	2 h
Hertz	300-500 Hz
Connection technology	Screw terminals
Contact	nickel plated contacts, highly heat resistant contact carrier
Protection type	IP 67
Flange	75x75 mm
Fixing hole	60x60 mm
Weight	236 g
Declaration of Conformity	EAC

## Drawing

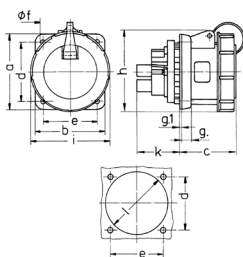

Drawing 1 MB 217/1	Amp. Poles	16		32		63	
		3	5	3	5	5	
Dim. in mm	a	75	75	85	85	107	
	b	75	75	75	75	100	
	c	60	60	67	73	82	
	d	60	60	60	60	85	
	e	60	60	60	60	77	
	f	5.5	5.5	5.5	5.5	6.5	
	g	8	8	8	8	12	
	g-1	2	2	2	2	2	
	h	81	95	95	106	115	
	i	70	88	94	102	114	
	k	26	27	34	34	55	
	l	52	57	58	65	88	
Terminal for cond. cross section (mm <sup>2</sup> ) min.-max.		1.5	1.5	2.5	2.5	6	
		-4	-4	-10	-10	-25	