

Panel mounted socket TM

Part no. 23293A



- screw terminals
- highly heat resistant contact carrier
- nickel plated contacts
- straight
- (form AS)

Technical specifications

Ampere	32 A
Poles	3 p
Voltage	230 V
Clock position	6 h
Hertz	50-60 Hz
Connection technology	Screw terminals
Contact	highly heat resistant contact carrier, nickel plated contacts
Protection type	IP 67
Flange	85x75 mm
Fixing hole	60x60 mm
Weight	281 g
Declaration of Conformity	EAC

Drawing

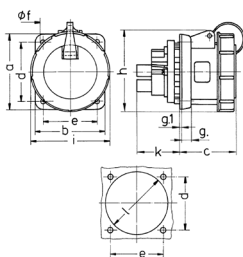

Drawing 1 MB 217/1	Amp. Poles	16		32		63	
		3	5	3	5	5	
Dim. in mm	a	75	75	85	85	107	
	b	75	75	75	75	100	
	c	60	60	67	73	82	
	d	60	60	60	60	85	
	e	60	60	60	60	77	
	f	5.5	5.5	5.5	5.5	6.5	
	g	8	8	8	8	12	
	g-1	2	2	2	2	2	
	h	81	95	95	106	115	
	i	70	88	94	102	114	
	k	26	27	34	34	55	
	l	52	57	58	65	88	
Terminal for cond. cross section (mm ²) min.-max.		1.5	1.5	2.5	2.5	6	
		-4	-4	-10	-10	-25	