

Panel mounted socket
Part no. 2765A



- screw terminals

Technical specifications

Ampere	16 A
Poles	5 p
Voltage	600-690 V
Clock position	5 h
Hertz	50-60 Hz
Connection technology	Screw terminals
Contact	standard
Protection type	IP 44
Flange	100x92 mm
Fixing hole	85x77 mm
Inclination	20 °
Weight	201 g
Declaration of Conformity	EAC

Drawing

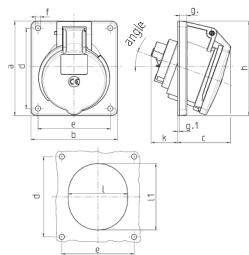

Drawing		16			32		
1 MB 260		3			4		
Dim. in mm		5			5		
a	73.5	100	100	100	100	100	100
b	64	92	92	92	92	92	92
c	50	59	58	62	62	61	61
d	60	85	85	85	85	85	85
e	52	77	77	77	77	77	77
f	5.5	5.5	5.5	5.5	5.5	5.5	5.5
g	7	8	8	8	8	8	8
g-1	2	2	2	2	2	2	2
h	79	100	100	103	103	106	106
k	44	34	34	54	54	49	49
l	52	55	65	67	67	72	72
l1	60	63	72	82	82	85	85
α	20°	20°	20°	20°	20°	20°	20°
Terminal for cond. cross		1.5	1.5	1.5	2.5	2.5	2.5
section (mm²) min.-max.		—4	—4	—4	—10	—10	—10