

Panel mounted socket with TwinCONTACT

Part no. 3590



- screwless spring terminals
- standard flange dimensions
- suitable for through wiring
- 20° inclination
- sockets optional fitted with auxiliary contact

Technical specifications

| | |
|---------------------------|-------------------------|
| Ampere | 32 A |
| Poles | 5 p |
| Voltage | 400 V |
| Clock position | 6 h |
| Hertz | 50-60 Hz |
| Connection technology | Screwless - TwinCONTACT |
| Contact | standard |
| Protection type | IP 67 |
| Flange | 85x85 mm |
| Fixing hole | 70x70 mm |
| Inclination | 20 ° |
| Weight | 235 g |
| Declaration of Conformity | VDE, EAC, CQC |

Drawing

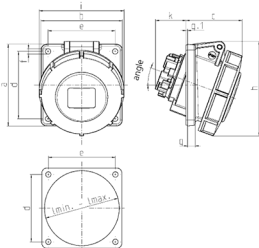

| Drawing 1 MB 520 | Amp. Poles | 16 | | | 32 | | |
|---------------------|---|-----|-----|-----|-----|-----|-----|
| | | 3 | 4 | 5 | 3 | 4 | 5 |
| Dim. in mm | a | 85 | 85 | 85 | 85 | 85 | 85 |
| | b | 85 | 85 | 85 | 85 | 85 | 85 |
| | c | 56 | 59 | 59 | 64 | 64 | 71 |
| | d | 70 | 70 | 70 | 70 | 70 | 70 |
| | e | 70 | 70 | 70 | 70 | 70 | 70 |
| | f | 5.5 | 5.5 | 5.5 | 5.5 | 5.5 | 5.5 |
| | g | 8 | 8 | 8 | 8 | 8 | 8 |
| | g.1 | 2 | 2 | 2 | 2 | 2 | 2 |
| | h | 87 | 91 | 99 | 103 | 103 | 110 |
| | i | 78 | 85 | 89 | 103 | 103 | 106 |
| | k | 32 | 32 | 33 | 44 | 44 | 49 |
| | I min. | 57 | 64 | 70 | 78 | 78 | 78 |
| | I max. | 76 | 76 | 76 | 78 | 78 | 78 |
| | Terminal for cond. cross section (mm ²) min.-max. | 1.5 | 1.5 | 1.5 | 2.5 | 2.5 | 2.5 |
| | | -4 | -4 | -4 | -6 | -6 | -6 |