

Wall mounted socket

Part no. 75276



- switched
- electrical interlock
- seawater resistant design available on request

Technical specifications

| | |
|---------------------------|-----------------|
| Ampere | 200 A |
| Poles | 5 p |
| Voltage | 400 V |
| Clock position | 6 h |
| Hertz | 50-60 Hz |
| Connection technology | Screw terminals |
| Contact | standard |
| Protection type | IP 55 |
| Weight | 31000 g |
| Declaration of Conformity | EAC |

Drawing

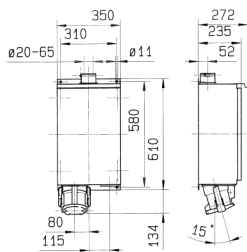

Drawing
1 MB 387
Dim. in mm