

Panel mounted socket TM

Part no. 24643



- screw terminals
- highly heat resistant contact carrier
- nickel plated contacts
- 20° inclination
- (form BS)

Technical specifications

| | |
|-----------------------|---|
| Ampere | 16 A |
| Poles | 5 p |
| Voltage | 50-500 V |
| Clock position | 2 h |
| Hertz | 300-500 Hz |
| Connection technology | Screw terminals |
| Contact | highly heat resistant contact carrier, nickel plated contacts |
| Protection type | IP67 |
| Flange | 85x85 mm |
| Fixing hole | 70x70 mm |
| Inclination | 20 ° |
| Weight | 235 g |
| Certifications | VDE |

Drawing

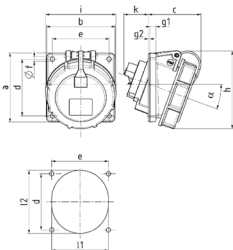

| Drawing 1MB474 | Amp. Pole | 16 | | 32 | | 63 |
|---|--------------|-----|-----|-----|-----|-------|
| | | 3 | 5 | 3 | 5 | 3/4/5 |
| Dim. in mm | a | 85 | 85 | 85 | 85 | 114 |
| | b | 85 | 85 | 85 | 85 | 114 |
| | c | 66 | 65 | 67 | 78 | 98 |
| | d | 70 | 70 | 70 | 70 | 90 |
| | e | 70 | 70 | 70 | 70 | 90 |
| | f | 5.5 | 5.5 | 5.5 | 5.5 | 6.5 |
| | g | 8 | 8 | 8 | 8 | 12 |
| | g.1 | 2 | 2 | 2 | 2 | 2 |
| | h | 89 | 97 | 101 | 108 | 135 |
| | i | 70 | 87 | 94 | 101 | 113 |
| | k | 40 | 35 | 54 | 43 | 62 |
| | l min. | 57 | 70 | 78 | 78 | 92 |
| | l max. | 78 | 78 | 78 | 78 | 105 |
| | o | 20 | 20 | 20 | 20 | 15 |
| Terminal for cond. cross section (mm ²) min.-max. | | 1.5 | 1.5 | 2.5 | 2.5 | 6 |
| | | -4 | -4 | -10 | -10 | -25 |